

PINE COURT HOUSING
ASSOCIATION



FIRE SAFETY IN YOUR HOME

RETIREMENT HOUSING

01

OUR SERVICE TO YOU

RETIREMENT HOUSING SCHEMES HAVE NO GREATER RISK OF FIRE THAN OTHER TYPES OF HOMES. HOWEVER YOU SHOULD ALWAYS CONSIDER YOUR FIRE SAFETY, AND THE IMPACT IT MAY HAVE ON OTHER RESIDENTS, SHOULD ANYTHING HAPPEN.

We know nothing is more important than keeping you, your family and neighbours safe which is why you need to know what to do in the event of a fire no matter where you happen to be in the building.

02

DESIGNED WITH SAFETY IN MIND

PINE COURT HOUSING ASSOCIATION (PCHA) RETIREMENT HOUSING SCHEMES ARE BUILT TO DELAY THE SPREAD OF FIRE FOR UP TO AN HOUR. YOUR BUILDING HAS BEEN DESIGNED WITH FIRE SAFETY IN MIND.

LIFT ACCESS

Never use the lift when evacuating the building. Fires can cause power failures which might leave you trapped inside.

EMERGENCY ACCESS

Never block emergency access to your building. This could include blocking doors with mobility scooters and other mobility aids. The Fire and Rescue Service need to get as close as possible to the building.

FIREFIGHTING SAFETY SYSTEMS

Fire detection systems are installed throughout the building. When activated, a signal is sent to a remote monitoring station who will immediately contact the Fire and Rescue Service and PCHA.

- In the event the communal area fire alarm does activate, the passenger lifts in the scheme will travel to ground and remain in that position until the reason for the activation has been investigated and the fire alarm is reset.
- The lifeline system in your home also includes a smoke detector in the lounge and a heat detector in your kitchen. If a detector is activated, a signal will be sent to the remote monitoring service who will contact you, the Fire and Rescue Service and PCHA.
- A member of the PCHA team will test the communal fire alarm weekly to ensure it is in full working order. There are posters around the building advising the day and time these tests will take place, during which time an alarm will sound briefly.
- Emergency call points (red boxes) can be found within the communal areas located by final exit doors and staircases. In the event that you discover a fire, pressing the emergency call point will activate the fire alarm.
- If you suspect any of these systems are damaged or not working please contact PCHA immediately.

03

HEAT/SMOKE DETECTORS

Working heat/smoke detectors save lives. In fact, you are seven times more likely to encounter a fatal fire in the home if you don't have working detectors.

All heat/smoke detectors in your home should be working. If you suspect the detector(s) in your home are not working for any reason, please contact us.

Periodically throughout the year PCHA staff will look to access your home and test the detectors to ensure they are working properly.



**DON'T IGNORE A SOUNDING
DETECTORS! EVEN IF IT IS NOT
YOURS, A NEIGHBOUR COULD
BE RELYING ON YOU.**



04

FIRE SAFETY IN YOUR HOME

SMOKING

Smoking is the most common cause of fatal fires, which is why the safest option is to not smoke. But if you do, please make sure you:

- Once finished, safely extinguish all cigarettes.
- Never discard cigarette butts out of your windows or from a balcony. For safe disposal, wet the stub and place in your bin.
- Do not smoke in bed or anywhere you may fall asleep.
- Never leave a lit cigarette or pipe unattended.
- Use proper ashtrays and never throw hot ash into the bin.
- Keep matches and lighters out of children's reach.

If you need any help or advice quitting please contact Smokefree National Helpline on **0300 123 1044**.

If you are now vaping as an alternative, remember to follow the manufacturer's instructions. Always use the correct charger and never use an e-cigarette if it is damaged in any way.

Our staff will complete a person centred fire risk assessment annually (at a minimum) to help you plan what you need to do in the event of a fire in your home, it is important that you engage in this process.

If our staff identify any concerns relating to your own fire safety awareness, we will refer you to the Fire and Rescue Service who may want to carry out a home visit to discuss with you how best to personally manage fire safety in your home. You can also contact the Fire and Rescue Service direct on **0800 731 5958** to request a home visit.

COOKING

- Never leave pans unattended when cooking.
- Don't cook if you are tired, have been drinking alcohol or taking medication that might make you drowsy.

If your pan catches fire:

- Don't tackle the fire yourself or try to move the pan.
- Never throw water on to the fire as this can create a fireball.
- Follow the Fire Action Notice, which includes leave the room and close the door. Shout to warn others to get out, stay out and call 999.
- If safe to do so, turn off the heat.

APPLIANCES

Always check the plugs and leads of any appliances and if they look frayed, scorched or damaged then do not use them.

If you have a tumble dryer, keep the lint tray and drum clear of any build up of fluff and debris as this can ignite if left unattended.

It's also important that you review the safety guidance for the make and model of your appliances as some are known to contain defects which can lead to fires.

GAS CANNISTERS

To reduce the risks of fire you should not use, permit to be used and/or store compressed gas within your home or any communal areas. If you are required to use and/or store compressed gas for medical reasons (e.g. oxygen), you must notify PCHA immediately.

ELECTRICS

- Never overload electrical sockets or leave items unattended.
- Keep electrical appliances clean and in good working order.
- Only leave essential appliances switched on, such as the fridge or freezer. Turn all other electrical items off when they are not in use.

CANDLES AND TEA LIGHTS

- Please avoid the use of candles or similar items with a naked flame wherever possible, but if you do use them, any candles should only be placed in stable, heat resistant holders.
- Keep them away from materials that may catch fire such as curtains, furniture, papers and clothes.



05

COMMUNAL AREAS

EVERYONE IS RESPONSIBLE FOR FIRE SAFETY IN THEIR OWN HOME AND WITHIN THE BUILDING, INCLUDING ANY COMMUNAL AREAS (I.E. COMMUNAL HALLWAYS, LOUNGES, STAIRWELLS, LAUNDRY ROOMS AND BIN ROOMS ETC.).

Please follow these tips to keep your communal areas fire safe.

BIN ROOMS AND COMMUNAL AREA CUPBOARDS

Please do not place any combustible items in the bin room or communal area cupboards. If you need to dispose of any large items (i.e. mattresses, furniture etc.) please call your local authority to arrange, or if you need assistance with this contact PCHA.

RUBBISH

Do not leave rubbish, bikes, mobility scooters, prams, items of furniture, carpets or any other items in any communal areas.

All of these items are a fire risk and could prevent easy passage along the escape routes should you and others need to evacuate the building, and can also delay the Fire and Rescue Service accessing these areas.

SMOKING

Do not smoke in any communal area.

As per the Smoke Free Regulations 2006 it is illegal to smoke in any public internal communal areas. Smoking will activate the communal fire detection systems.

If we confirm you or a visitor to your home is responsible for a false fire alarm we will recharge you for the cost of our engineers and the Fire and Rescue Service to attend.

EMERGENCY LIGHTING

If you notice any damage to light fittings throughout the building or if they are not working properly, please contact us immediately.

FIRE DOORS

In the majority of our schemes the communal corridor fire doors will remain open via their magnetic lock function and will only close on activation of the fire alarm system. This is to prevent the passage of smoke and heat through the corridors.

Keep fire doors closed and do not open them. They are there to stop fires from spreading. PCHA may need to periodically inspect your own flat entrance door to ensure it is operating and fitting correctly.

All other doors (including your flat entrance door) must be kept closed. Any self closing devices on doors must not be removed or tampered with, as this will result in fire spreading to other parts of the building.

Please report to us straight away if you notice:

- A fire door is damaged or not fitting fully into its frame.
- Fire doors being wedged open.
- A fire door is not closing correctly.

YOU MUST NEVER DISCONNECT THE SELF CLOSING DEVICE TO ANY FIRE DOORS IN THE BUILDING, INCLUDING THOSE ON YOUR OWN FLAT DOOR.

06

ESCAPE ROUTE - HAVE A PLAN!

STEP 1

In the event of a fire in your flat, it's always best to be prepared. Make sure you identify possible escape routes from every room and have an arranged meeting place outside so you're sure everyone in your flat has escaped.

STEP 2

Stay calm and gather all the members of your family and make your way out together through the nearest exit. If a door feels hot do not open it.

If you are trapped in a room by smoke or fire, you need to stop smoke getting into the room. Close the door and block any gaps around the door with spare clothing, towels or blankets.

If you can access a window in the room open it and shout to let others know you are trapped and what your flat number is.

Remain as calm as you can and await the emergency services to attend.

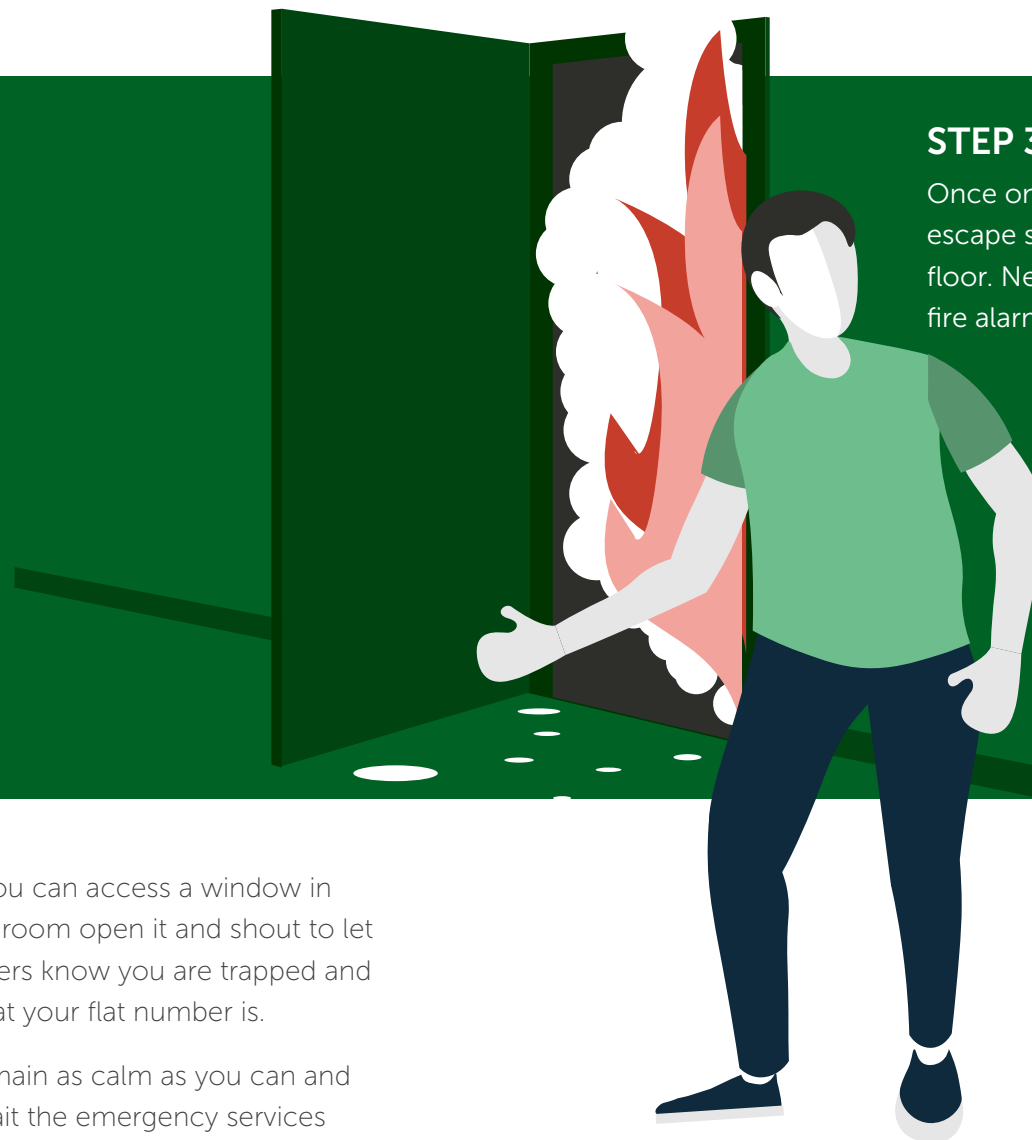

STEP 3

Once onto the communal corridor please use the escape stairwell to make your way to the ground floor. Never try to use the lifts. If the communal fire alarm is not sounding, and it is safe to do so, please activate the nearest Emergency Call Point.

STEP 4

When outside call 999 for the Fire and Rescue Service so they are aware of the fire. Stay out of the building until the Fire Service tells you it's safe.



SMOKE CAN BE DEADLY, BUT IF YOU HAVE TO GET THROUGH IT, CRAWL UNDER IT.

07

MAKE A BEDTIME CHECKLIST

- ✓ Close inside doors at night to stop a fire from spreading.
- ✓ Turn off and unplug electrical appliances unless they are designed to be left on (i.e. your fridge).
- ✓ Don't leave washing machines or dryers on overnight.
- ✓ Check your cooker is turned off.
- ✓ Put candles and cigarettes out properly.
- ✓ Make sure exit routes from your flat are kept clear.
- ✓ Make sure you turn off any mains powered fairy lights.

KNOWING HOW TO REACT IN A FIRE WILL ALWAYS GIVE YOU AND YOUR FAMILY THE BEST OPPORTUNITY OF REMAINING SAFE, SO PLEASE ENSURE EVERYONE IN YOUR HOME IS FAMILIAR WITH THE CONTENT OF THIS GUIDE AND THEY ADOPT THE HELPFUL TIPS PROVIDED.

FIRE ACTION NOTICE

In the event of a fire in your flat:

Ensure that everyone evacuates your flat immediately. Close the front door to your flat. Make your way out of the building, using the common escape route. Once you are outside the building, call the fire and rescue service by dialling **999**.

In the event of a fire elsewhere in the building:

The building is designed to contain a fire and allow you to remain in your flat in relative safety if the fire is in another flat or elsewhere in the building. If your flat is not affected by fire, you will be safe to remain in your flat. Leave your flat if it becomes affected by fire and smoke or you are directed to leave by the Fire and Rescue Service.

If you are in a common area:

Leave the building immediately - do not go back to your flat. Operate the nearest fire alarm call point.

Do not use the lifts

Once you are outside the building, call the Fire and Rescue Service by dialling **999**.

IMPORTANT NOTE: Where a 'stay safe' policy is in place, we would emphasise that if you are in any doubt that it is safe to remain in your flat and provided it is safe to use the common escape routes, then you should leave the building as quickly as possible.

Calling the Fire and Rescue Service:

Dial 999. When the operator answers, give your telephone number and ask for FIRE. When the Fire and Rescue Service answers, give them your address and the location of the fire. Do not end the call until the Fire and Rescue Service have confirmed the address.

If you need assistance understanding the information in this document, please contact us on **0300 365 1111**.

Chinese – 如果您需要幫助了解本文檔中的信息，請致電 0300 365 1111 與我們聯繫。

Lithuanian – Jei norite, kad Jums kas nors padėtų suprasti šiame dokumente pateiktą informaciją, prašome su mumis susisiekti tel **0300 365 1111**.

Polish – Jeśli potrzebujesz pomocy, by zrozumieć informacje zawarte w tym dokumencie, skontaktuj się z nami pod numerem **0300 365 1111**.

Portuguese – Caso necessite de assistência para compreender a informação constante neste documento, deverá contactar-nos através do **0300 365 1111**.

Russian – Если вам требуется разъяснение информации, содержащейся в данном документе, пожалуйста, свяжитесь с нами по телефону **0300 365 1111**.

Turkish – Bu belgede verilen bilgileri anlama konusunda desteğe ihtiyaciniz olursa lütfen bize ulaşın **0300 365 1111**.

Ukrainian – Якщо вам потрібна допомога в розумінні інформації у цьому документі, зв'яжіться з нами за номером **0300 365 1111**.